



Side Sill Panels/Side Sill Molding

Replacement

Disassemble in the numbered sequence.

NOTE: When removing the clips, loosen the screw, then remove the clips with a clip remover.

▷: Clip locations ,8

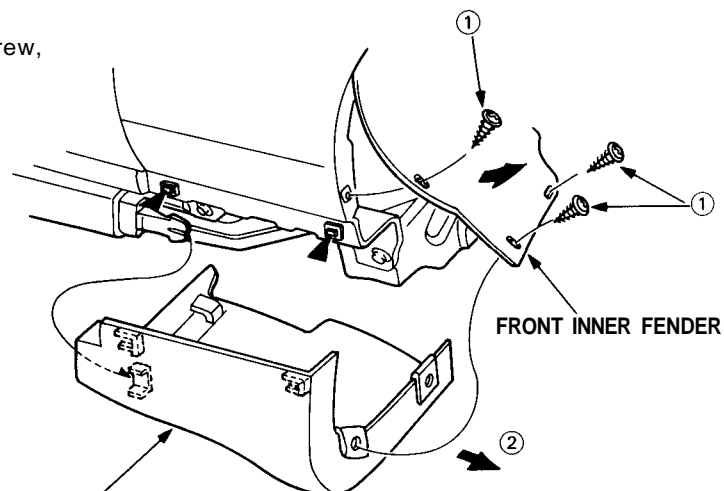
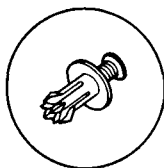

SIDE SILL PANEL
Remove the eight lower clips, then remove the side sill panel by sliding it forward.

FRONT SIDE SILL PANEL

SIDE SILL MOLDING

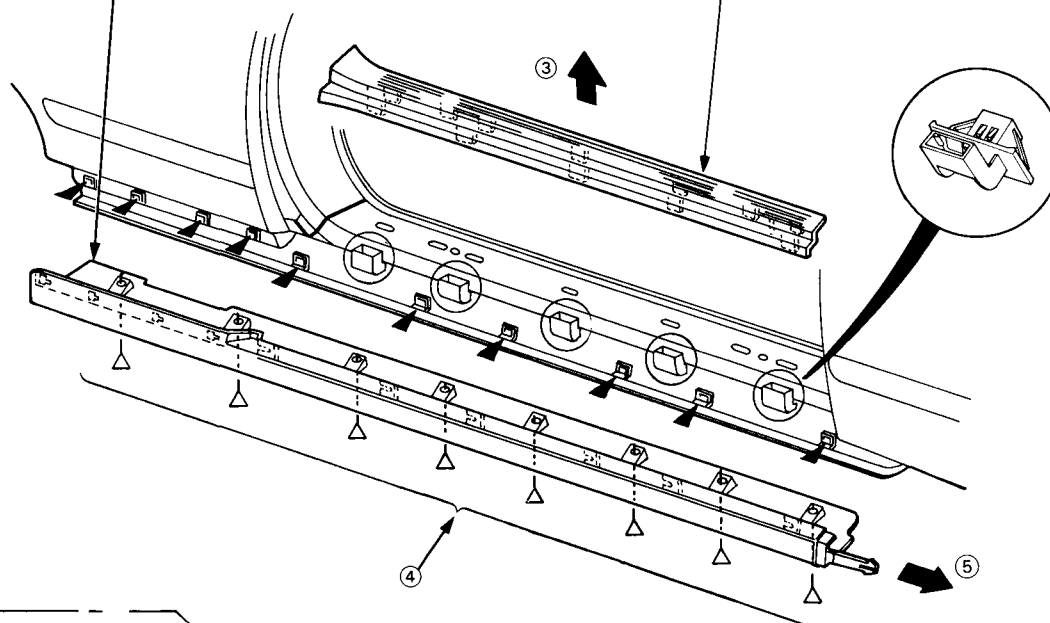

▷: Clip locations ,12

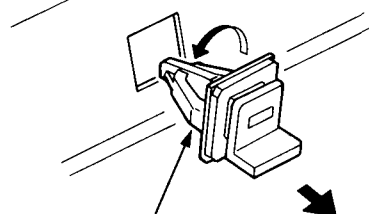

SIDE CLIP
Remove the side clips by turning them 45°

To install the side sill panel, remove the side clips from the body, install them on the side sill panel, then install the side sill panel on the car.

NOTE:

- Take care not to twist the side sill panel.
- If necessary, replace any damaged side and lower clips.